

A—N—D

VALE SERIES CEILING/WALL

DESIGNER
CAINE HEINTZMAN

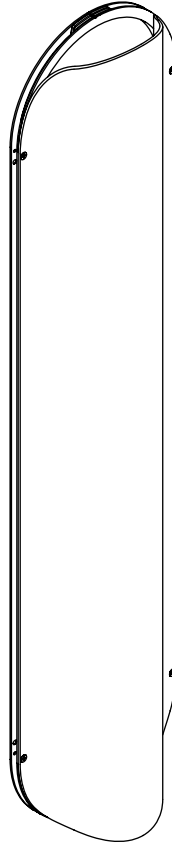

INSTRUCTIONS



SCAN HERE

WORLD MARKET



A-N-D.COM

INSTALLATION NOTES

It is recommended that two people install the Vale Ceiling/Wall: one to gently support the luminaire while the other makes the electrical and mechanical connections.

Both installers should wear clean gloves and take great care not to damage the luminaire.



CARE INSTRUCTIONS

Always wear clean gloves when handling the luminaire. Clean finished surfaces with a soft, lint-free cloth. Clean acrylic diffuser with a soft lint-free cloth and soap and water if necessary.

For replacement parts contact A-N-D directly. Never exceed the recommended wattage, as doing so may damage the luminaire or cause a fire.



WARNING

The luminaire must be installed by a qualified electrician in a dry indoor location.

Failure to meet any or all of these criteria will not only damage the luminaire, but will void both the warranty and all of its certifications.

Always ensure circuit breaker is off prior to making electrical connections.

LED DRIVER OPTIONS



The Vale CW LED driver varies depending on dimming requirements and input voltage.

Use the ordering code to determine the selected driver:
ie. VAL-1-CW-ANT-CLR-27-010-230

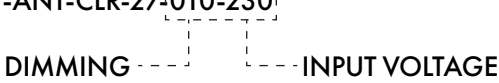

PHASE CUT DIMMING (PC)

M-28 SERIES - ES POWER
INPUT: 230VAC
OUTPUT: 24VDC, 24W
L x W x H: 89 x 42 x 31

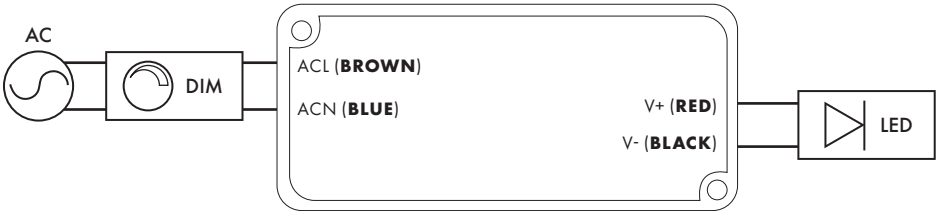

0-10 + PWM DIMMING (010)

Q22-P SERIES - ES POWER
INPUT: 110-277VAC
OUTPUT: 24VDC, 22W
L x W x H: 89 x 42 x 31

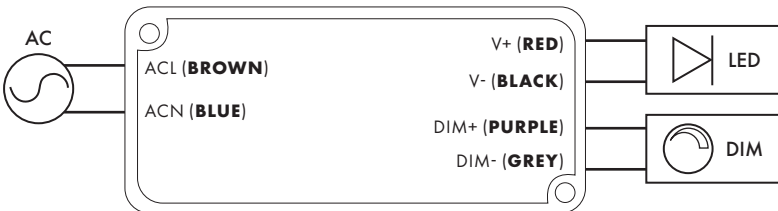

VALE OPTIONS

The Vale Ceiling/Wall can be installed on a ceiling or wall, vertically or horizontally.

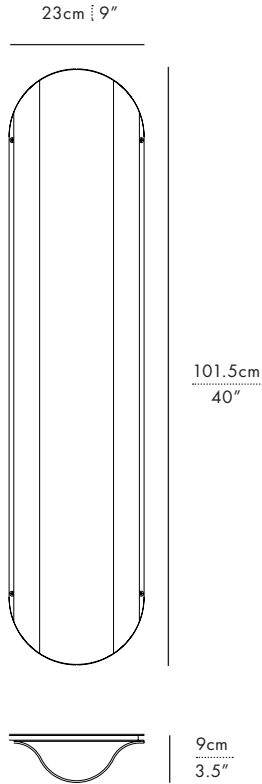

There are two installation options:

OPTION 1

Trimless: Frame is directly installed on ceiling or wall. This option is suitable for holes with jump wires in the ceiling or wall that are smaller than 20mm.

OPTION 2

Coverplate: A cover plate is installed between the frame and the ceiling or wall to cover larger holes.

COMPONENTS – OPTION 1



TRIMLESS (SURFACE MOUNT) * REMOTE DRIVER ONLY *

- ① WIRE NUT (2)
- ② DRIVER (REMOTE)
- ③ WOODSCREWS (2)
- ④ JUMP WIRE
- ⑤ FRAME
- ⑥ LED COMPONENT
- ⑦ CLEAR LENS SCREW (4)
- ⑧ LENS

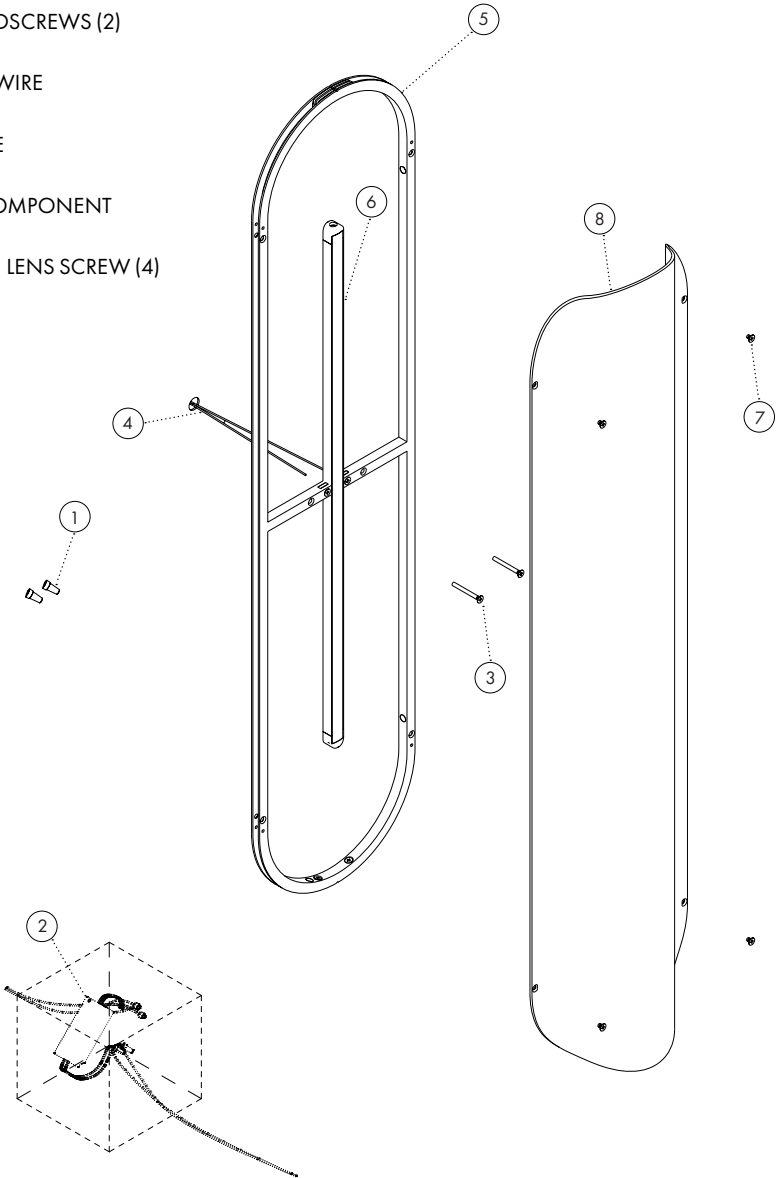

COMPONENTS — OPTION 2

COVER PLATE

- ① WIRE NUT (2)
- ② LED DRIVER (REMOTE)
- ③ WOODSCREWS (2)
- ④ JUMP WIRE
- ⑤ FRAME
- ⑥ LED COMPONENT
- ⑦ CLEAR LENS SCREW (4)
- ⑧ COVER PLATE
- ⑨ LENS

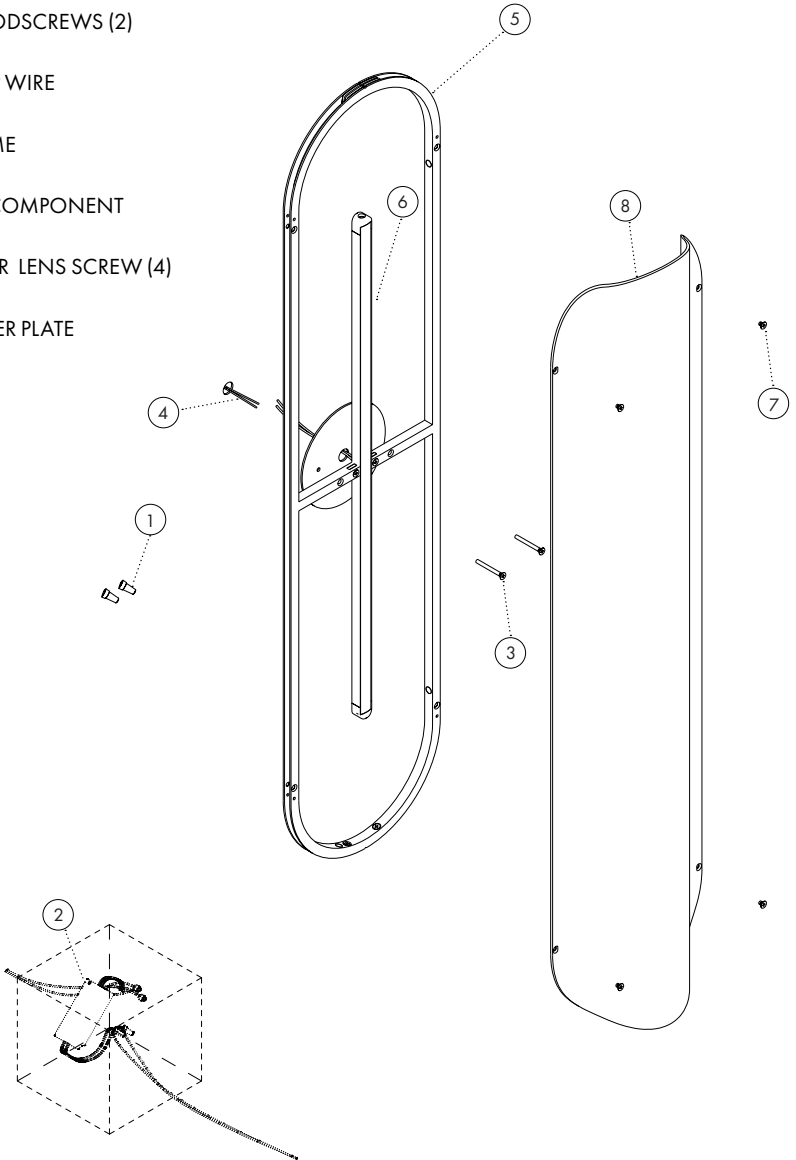

INSTALLATION



STEP 1

Turn off breaker.

Following driver **PAGE 3** and wiring diagram, connect mains to remote driver, and run low voltage wire to wall opening.

REFER TO PAGE 3: DRIVER OPTIONS FOR MORE DETAILS

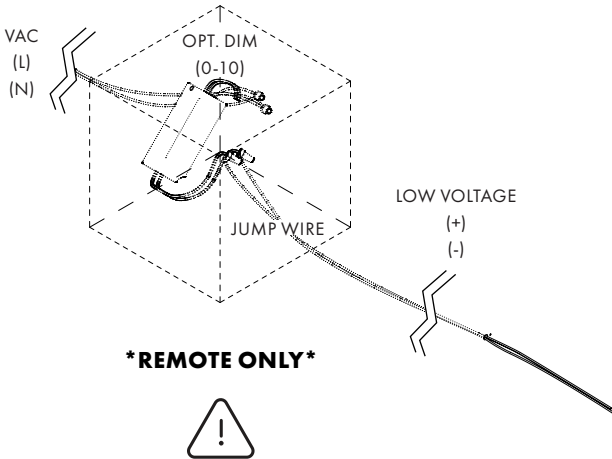
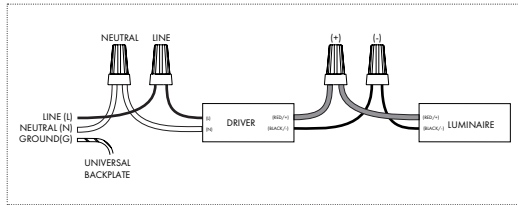

The next steps depend on the installation method selected.

TRIMLESS — PAGE 8

COVER PLATE — PAGE 10

INSTALLATION — OPTION 1

TRIMLESS (SURFACE MOUNT) *REMOTE DRIVER ONLY*

STEP 2

Connect low voltage jump wire from driver to luminaire. Be sure to match the poles (+ to +) and (- to -).

Tuck connectors into wall.

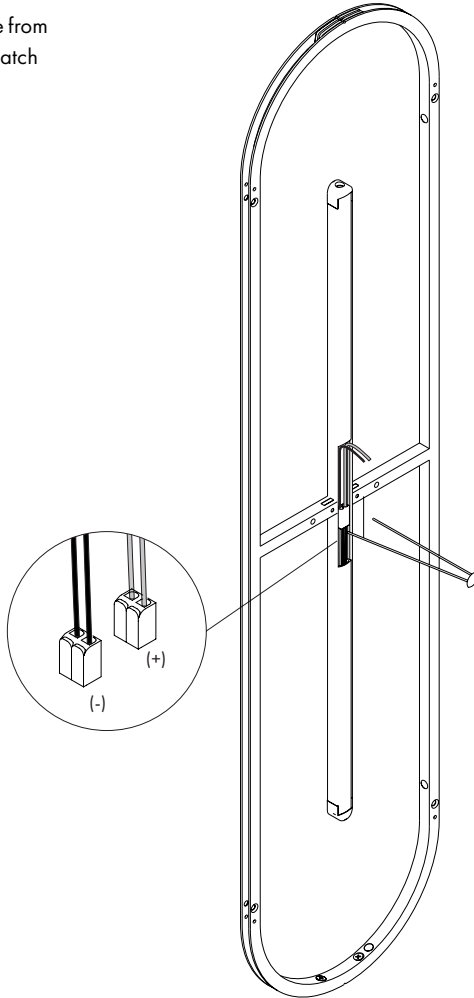

STEP 3

Using the provided wood/drywall screws, mount the Vale frame to the wall.

Use substrate specific anchors if necessary. Use a level to ensure proper orientation.

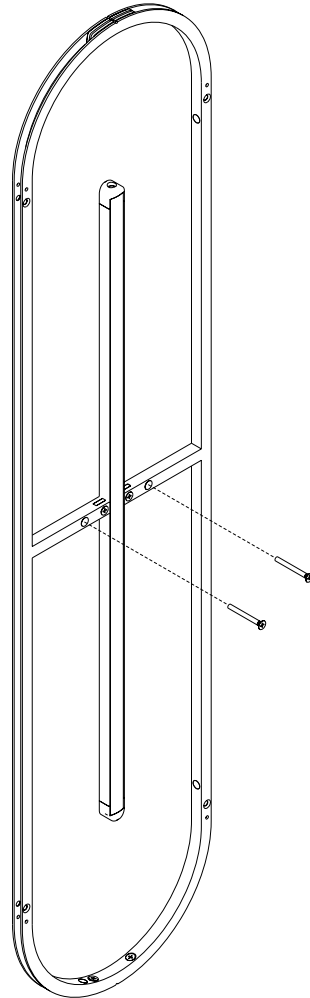

INSTALLATION — OPTION 2

COVER PLATE

STEP 2

Connect low voltage jump wire from driver to luminaire. Be sure to match the poles (+ to +) and (- to -).

Tuck connectors into wall.

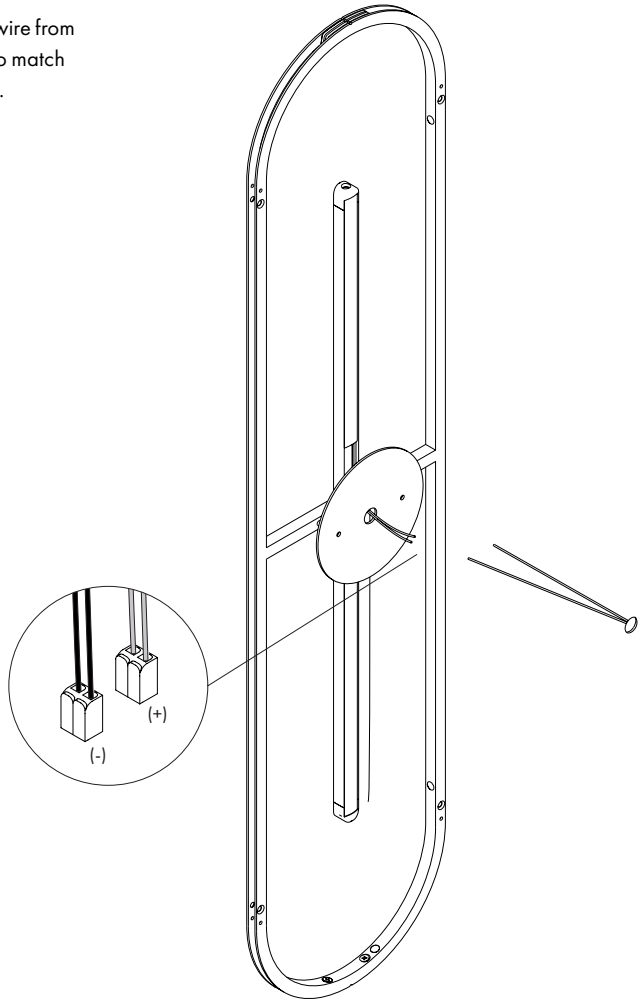

STEP 3

Using the provided wood/drywall screws, mount the Vale frame to the wall. Use substrate specific anchors if necessary. Use a level to ensure proper orientation.

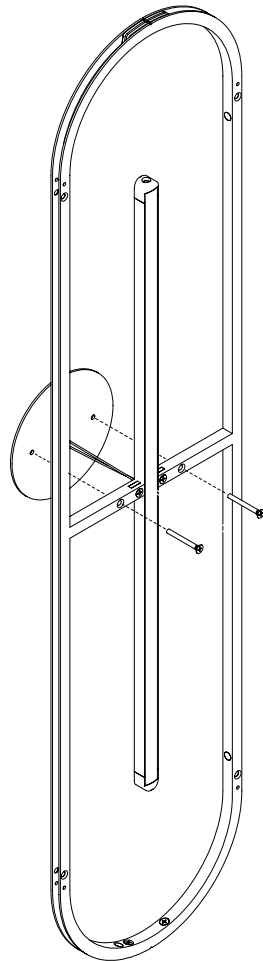

INSTALLATION

STEP 4

Using the clear polycarbonate screws, mount the lens to the frame.
Do not overtighten.

Your installation is now complete.

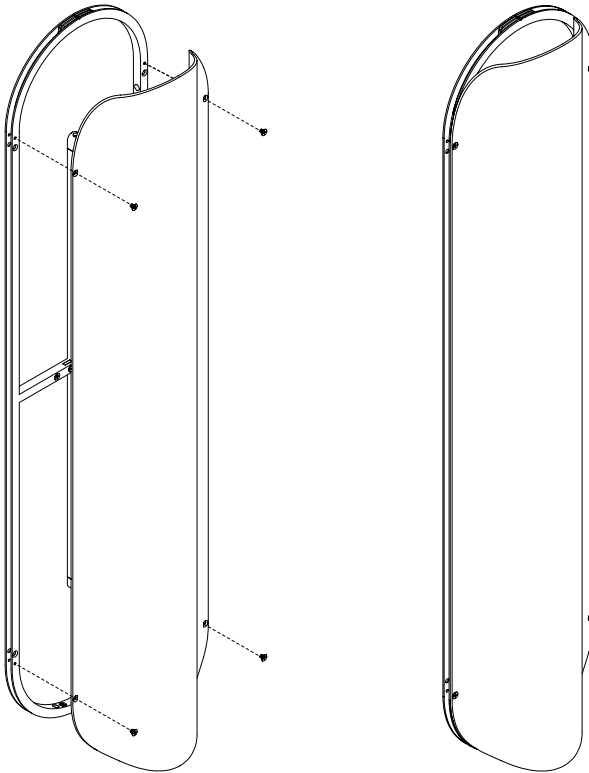

A—N—D

For support, please contact:
info@a-n-d.com
+1 604 563 6938

1951 Franklin St,
Vancouver, BC
Canada V5L 0C7