



# Pomme Pendant

22001 rA

Low Voltage Input

Note: External power supply may be required

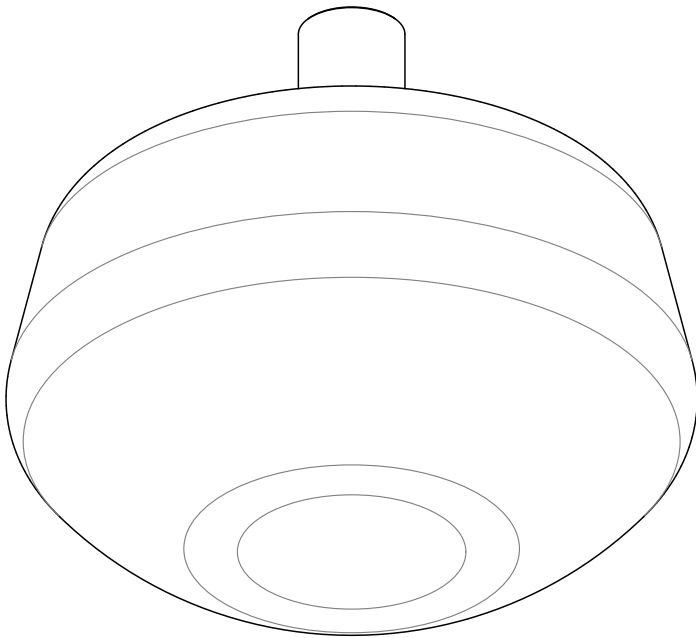

## CAUTION:

Before starting, turn off power  
at main circuit panel.

## ADVERTENCIA:

Antes de comenzar la instalación,  
apague la corriente en el tablero  
principal.

## ATTENTION:

Coupez l'alimentation avant de  
procéder à l'installation.



Calling for backup? Scan above  
to contact our team.

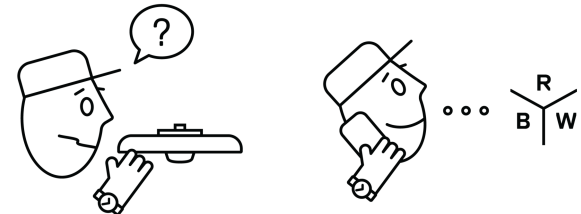

[www.RBW.com](http://www.RBW.com)  
+1 212 388 0399  
[support@RBW.com](mailto:support@RBW.com)  
© 2025, RBW Studio LLC

## What's Included: Part Configurations May Vary

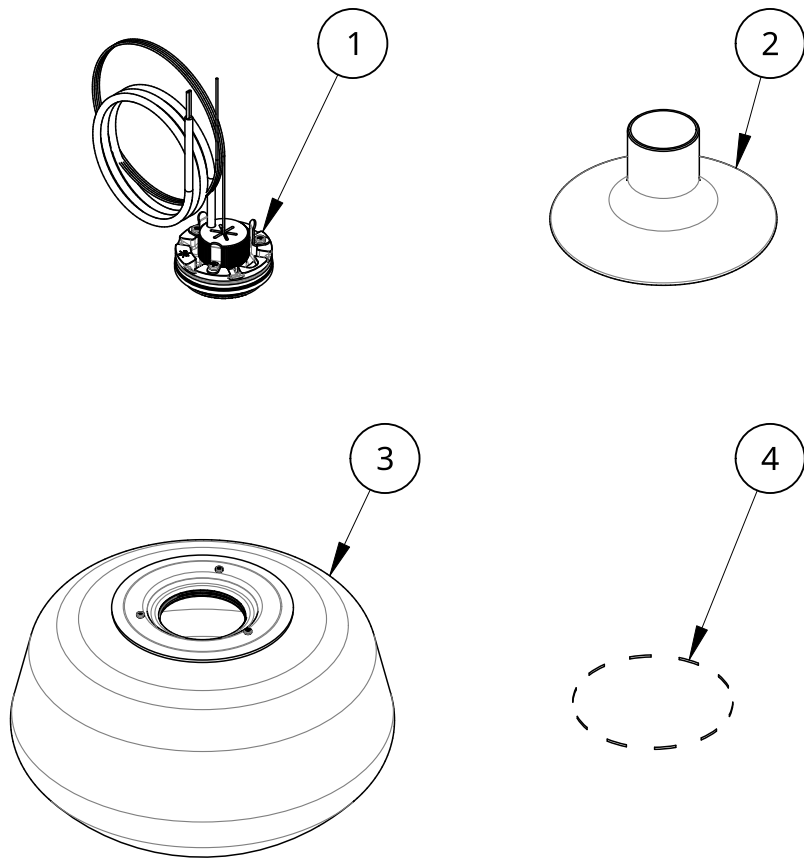

Item	QTY	Description
1	1	Assembly: Pomme. Pendant. LED Module
2	1	Pomme Shade
3	1	Pomme Globe
4	1	Canopy Kit

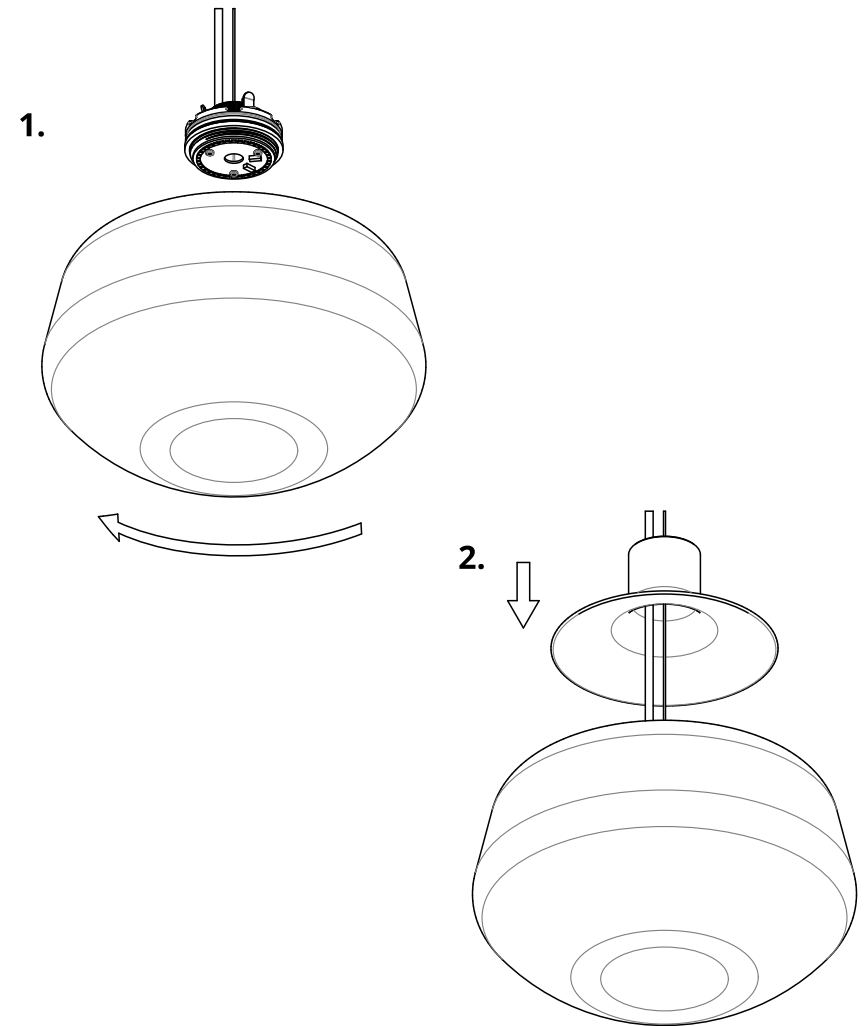

### Installation - Globe and Shade

1. Thread Globe clockwise onto LED Module.
2. Place Shade on top of Globe, feeding power cord and aircraft cable through the Shade center.

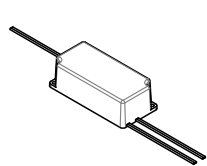

Driver dimensions and location may vary, consult your order confirmation for details.

3.

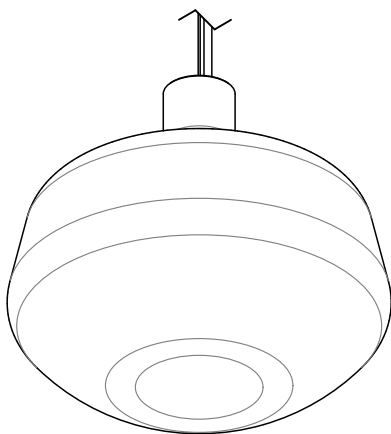

### Installation - Canopy

3. Refer to the following supplementary instructions for Canopy installation details:

Canopy Type	Instructions Part Number
Flat Canopy	14273
Deep Canopy	13163
Mud-in Canopy	21796

4.

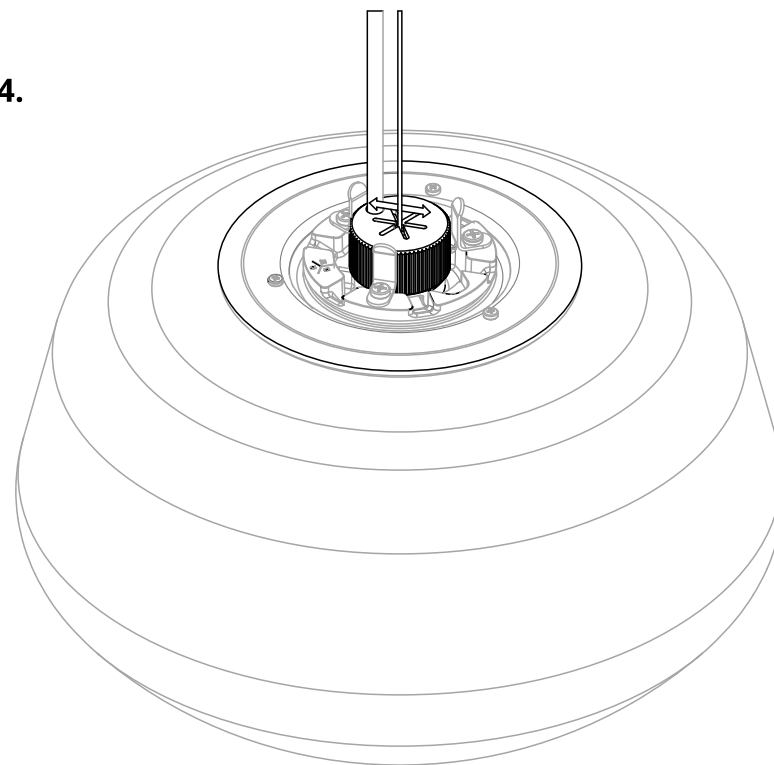

### Installation - Leveling

4. Once the luminaire is suspended from the canopy, final leveling can be done by sliding the aircraft cable in the slots on top of the LED module.
5. Congratulations! End of guide.