

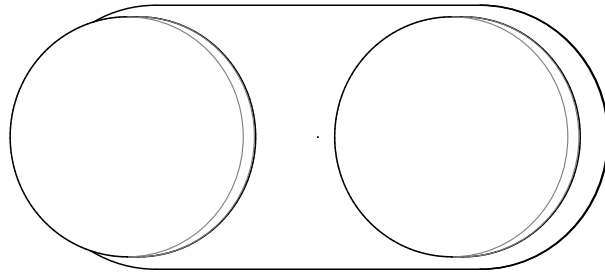

Pastille

21435 rA

Pastille 2
AC Input



CAUTION:

Before starting, turn off power at main circuit panel.

ADVERTENCIA:

Antes de comenzar la instalación, apague la corriente en el tablero principal.

ATTENTION:

Coupez l'alimentation avant de proceder à l'installation.



Calling for backup? Scan above to contact our team.

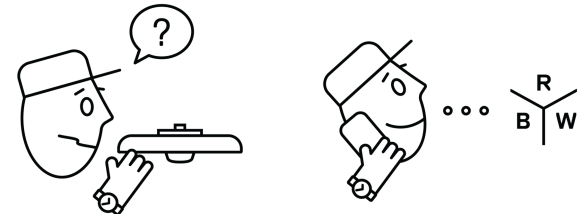

www.RBW.com

+1 212 388 1621

support@RBW.com

© RBW Studio LLC, 2013, 2020

What's Included: Part Configurations May Vary

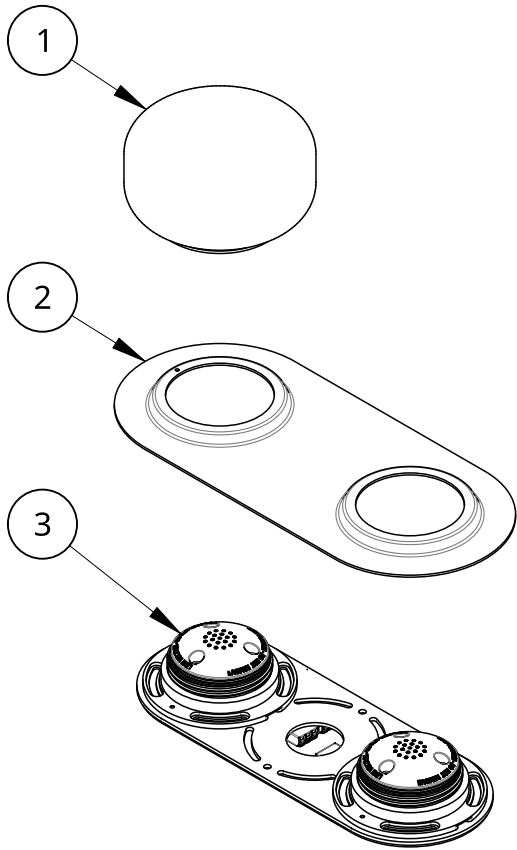

Item	Qty	Description
1	2	Pastille Glass
2	1	Pastille 2 Dress Plate
3	1	Assembly: Pastille 2

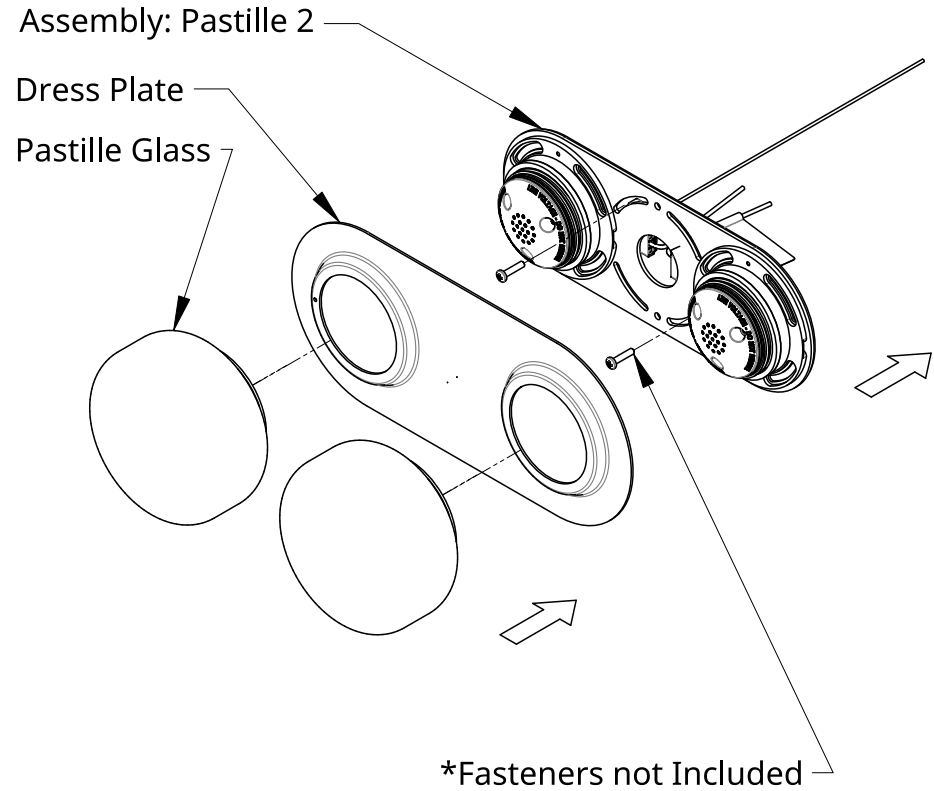

Installation - Pastille 2 AC

1. Connect Black (L) and White (N) leads to power feed.
2. Connect ground strap (GND).
3. Use appropriate fasteners to fasten the Assembly to the mounting surface or junction box.
4. Place Dress Plate over Pastille 2 Assembly.
5. Thread Pastille Glass onto Assembly to tightly secure Dress Plate.
6. Congratulations! End of guide.