



COLUMN SERIES

VERTICAL SINGLE – PENDANT

DESIGNER
LUKAS PEET

INSTRUCTIONS



SCAN HERE

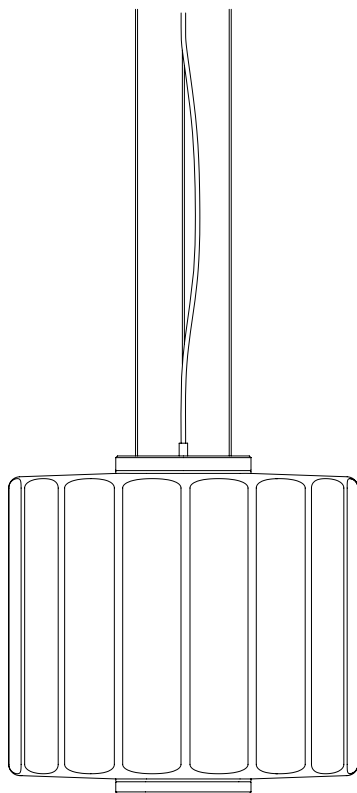

WORLD MARKET



a-n-d.com

INSTALLATION NOTES

The luminaire is powered by 24V DC. A constant voltage LED driver is required to operate the luminaire. The LED driver varies, depending on input voltage and dimming requirements.

It is recommended that two people install the Column Pendant; one to gently support the luminaire while the other makes the electrical and mechanical connections to the ceiling.

For questions regarding installation, please email **info@a-n-d.com**



CARE INSTRUCTIONS

Always wear clean gloves when handling the luminaire. Clean finished surfaces with a soft, lint-free cloth. Clean acrylic diffuser with a soft lint-free cloth and a diluted solution of dish soap in warm water.

For replacement parts contact A-N-D directly.



WARNING

The luminaire must be installed by a qualified electrician in a dry indoor location.

Failure to meet any or all of these criteria will not only damage the luminaire, but will void both the warranty and all of its certifications.

COMPONENTS



- ① BACKPLATE
- ② #8 SCREW (2)
- ③ LED DRIVER
- ④ TERMINAL (4)
- ⑤ CANOPY SCREW (3)
- ⑥ CANOPY
- ⑦ STRAIN RELIEF
- ⑧ STRAIN RELIEF PLASTIC SET SCREW
- ⑨ ELECTRICAL CORD
- ⑩ AIRCRAFT CABLE (3)
- ⑪ SUSPENSION CAP
- ⑫ GLASS
- ⑬ LED MODULE
- ⑭ ENDCAP

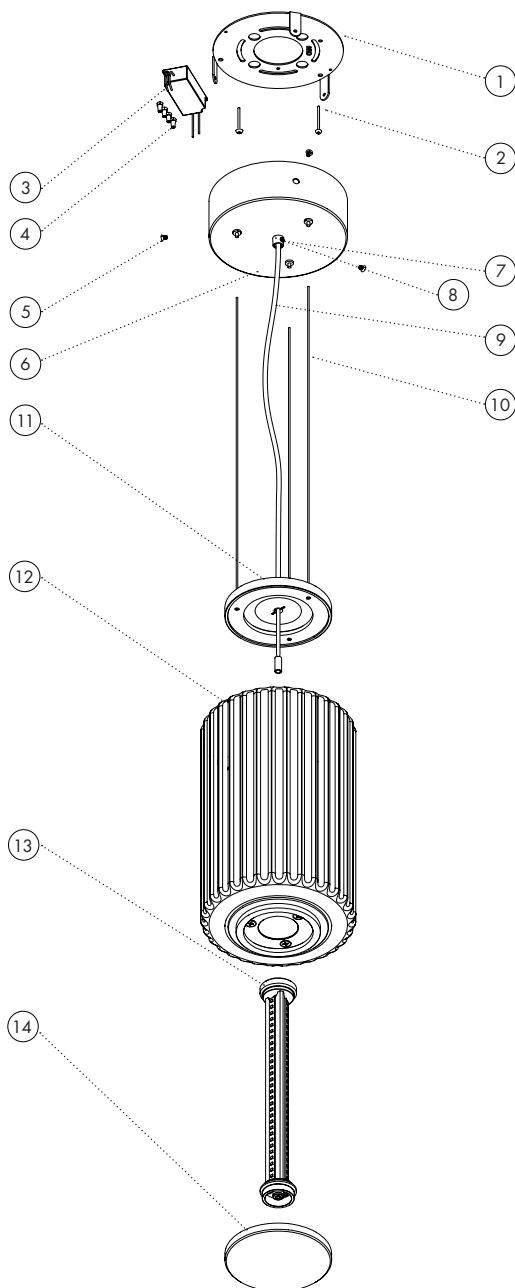

COLUMN OPTIONS

COLUMN 175 VERTICAL

WEIGHT: 7.9 lb / 3.6 kg

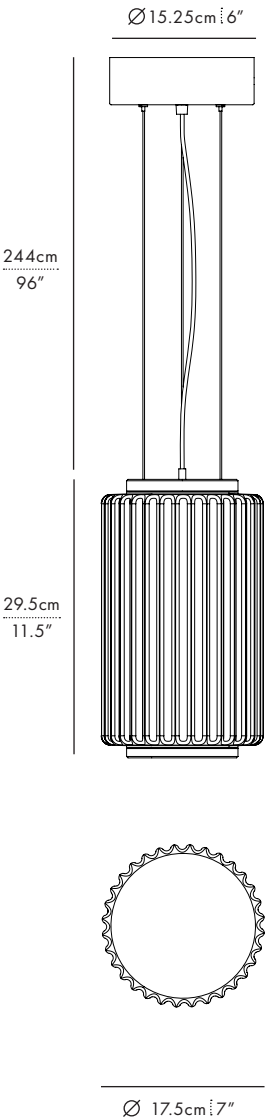

COLUMN 300 VERTICAL

WEIGHT: 11.7 lbs / 5.3 kg

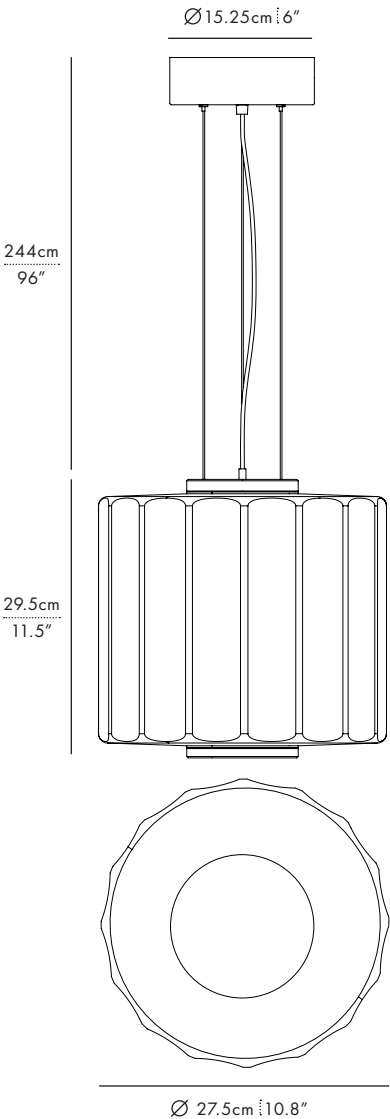

LED DRIVER OPTIONS



The Column Pendant LED driver varies depending on dimming requirements and input voltage.

Use the ordering code to determine the driver selected:

ie. COL-175-1-P-V-CBN-27-010-277

DIMMING --- INPUT VOLTAGE

PHASE CUT DIMMING (PC)

M-28 SERIES - ES POWER

INPUT: 230VAC

OUTPUT: 24VDC, 24W

L x W x H: 89 x 42 x 31

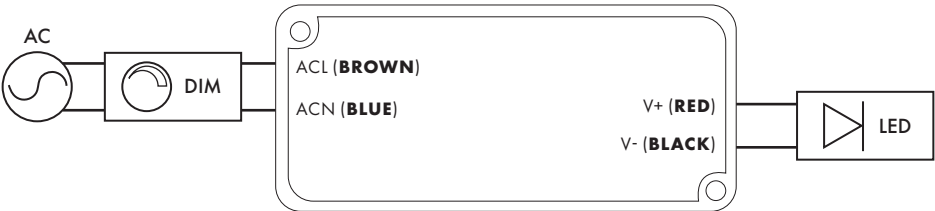

0-10 + PWM DIMMING (010)

Q22-P SERIES - ES POWER

INPUT: 1108-277VAC

OUTPUT: 24VDC, 22W

L x W x H: 89 x 42 x 31

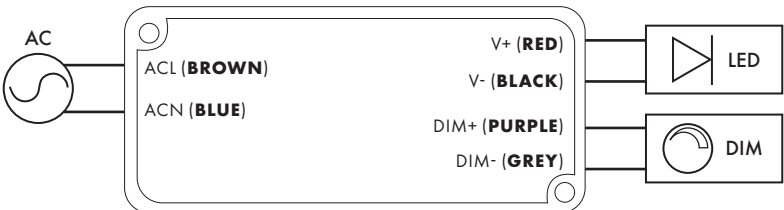

INSTALLATION

STEP 1

Remove the wrapped LED module from the glass box and set aside.

The separate box contains all the required hardware for assembly.

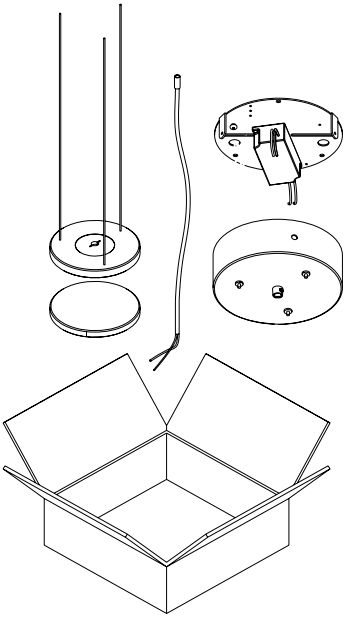
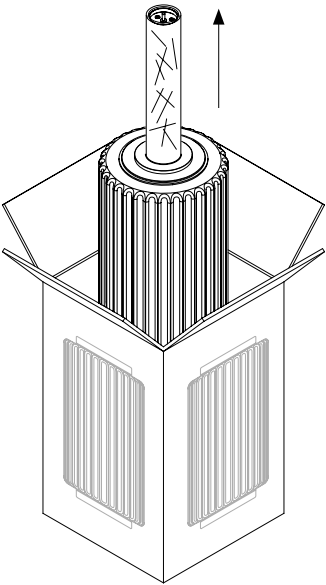

INSTALLATION



STEP 2

Mount the backplate to the ceiling.

Use the provided #8 screws.
Anchors are provided by installer.

⚠ Caution!

Ensure that the power is disconnected at the breaker.

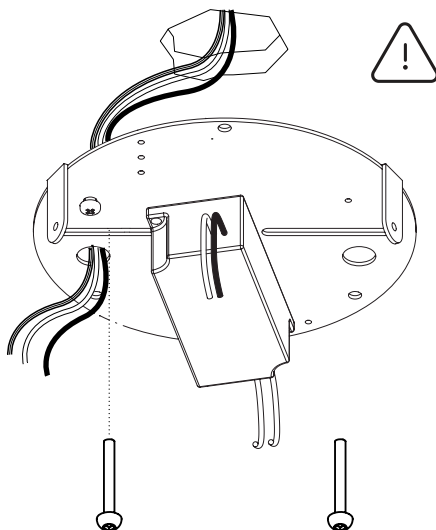

STEP 3

Connect the primary circuit on the LED driver to input power. Connect ground.

Black/brown wire = **Line** (L)

White/blue wire = **Neutral** (N)

Green screw = **Ground** (G)

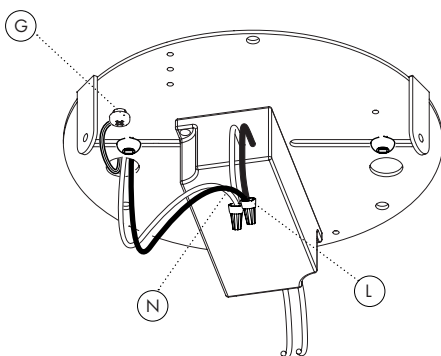

REFER TO PAGE 5: DRIVER OPTIONS FOR MORE DETAILS

INSTALLATION

STEP 4

Feed the aircraft cable (3) and the electrical cord through the canopy.

⚠ Attention!

Do not cut any cable/power cord at this step.

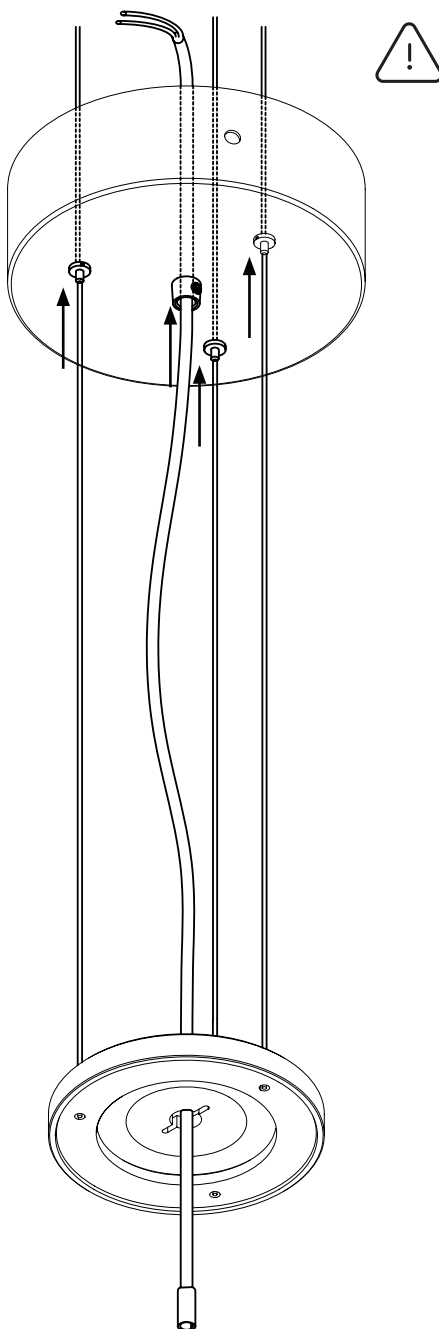

STEP 5

Determine the drop height and trim the excess electrical cord and aircraft cable.

Refer to **PAGE 4 & 5** for the light fixture total height.

⚠ Attention!

Leave an extra 15cm / 6" of aircraft cables and powercord inside the canopy.

Leave an extra 15cm / 6" powercord below the suspension cap.

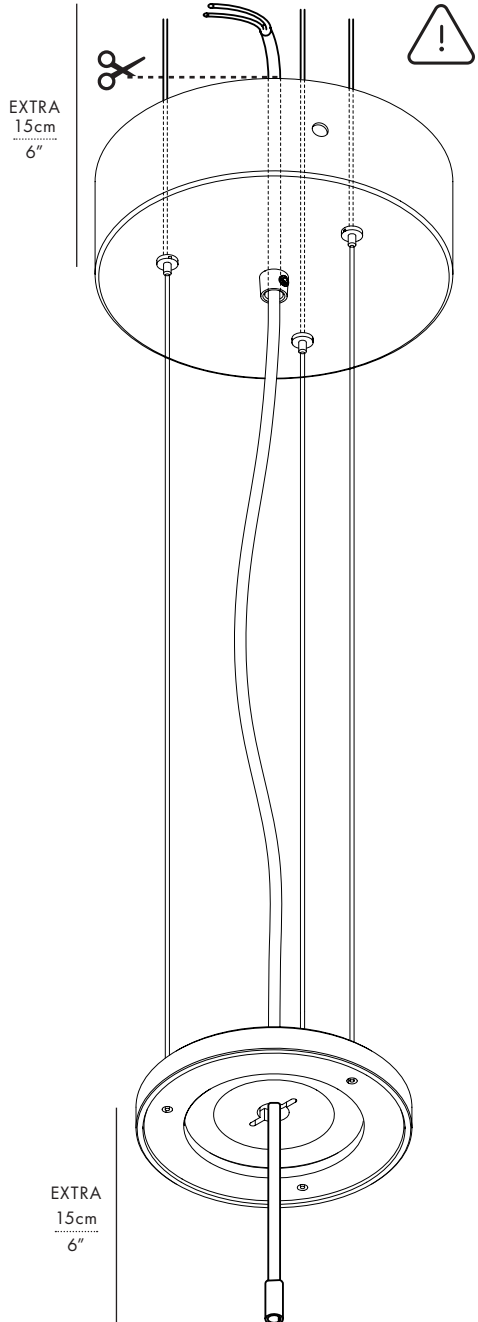

INSTALLATION

STEP 6

Connect the luminaire to secondary circuit on LED driver.

Dashed line/red = **Positive** (V+)

Black = **Negative** (V-)

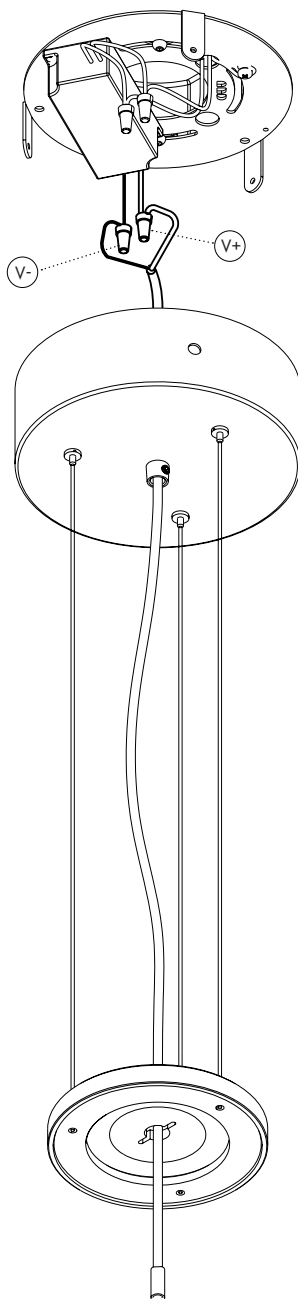

STEP 7

Using the provided canopy screws (3), attach the canopy to the backplate.

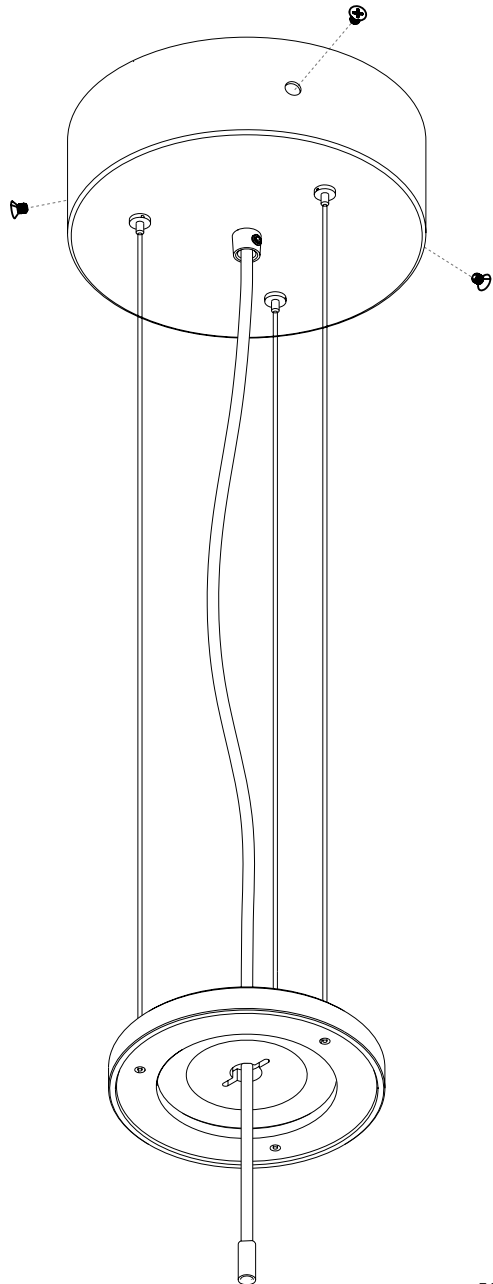

INSTALLATION

STEP 8

Ensure the suspension cap is levelled to the ceiling.

While pushing the cable gripper, pull/feed the aircraft cables one at a time.

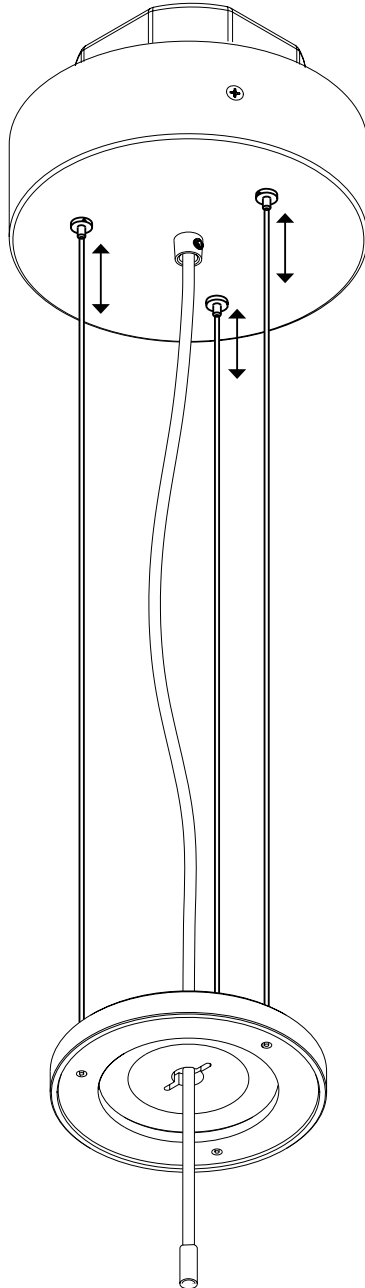
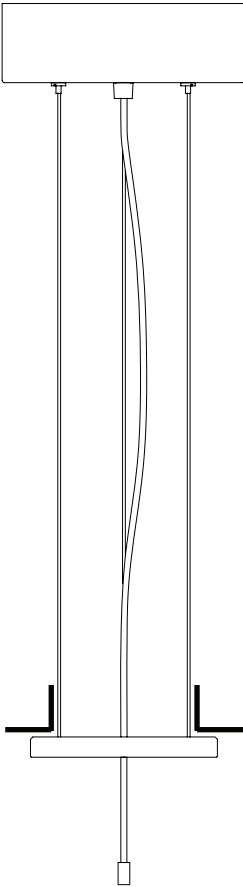

STEP 9

Thread the glass onto the suspension cap by turning clockwise.

Attention!

Remove rings/jewelry from fingers to prevent breakage during this step.

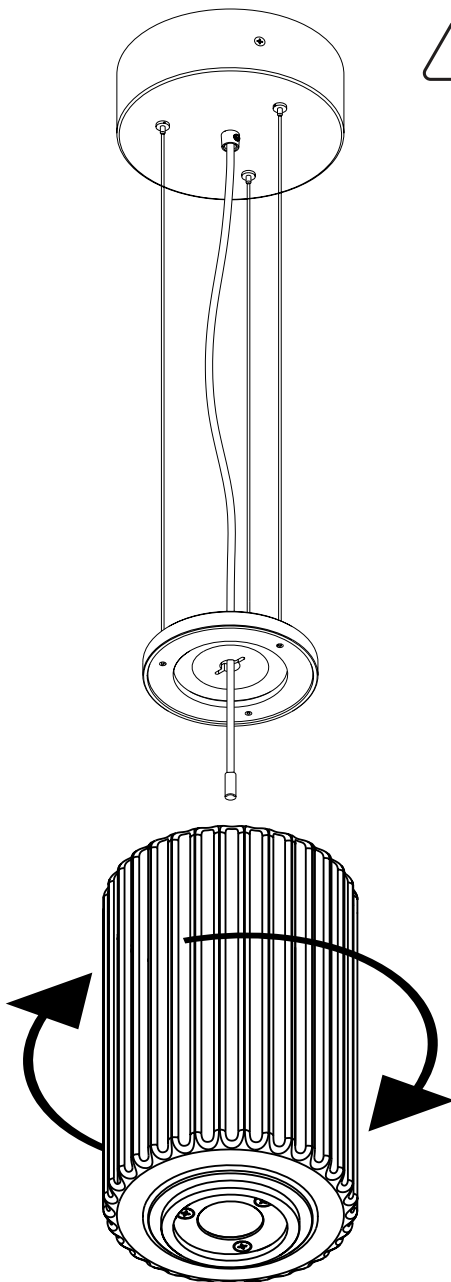

INSTALLATION

STEP 10

Slide the LED module from the bottom glass

Ensure the side with the DC JACK is facing up in the fixture.

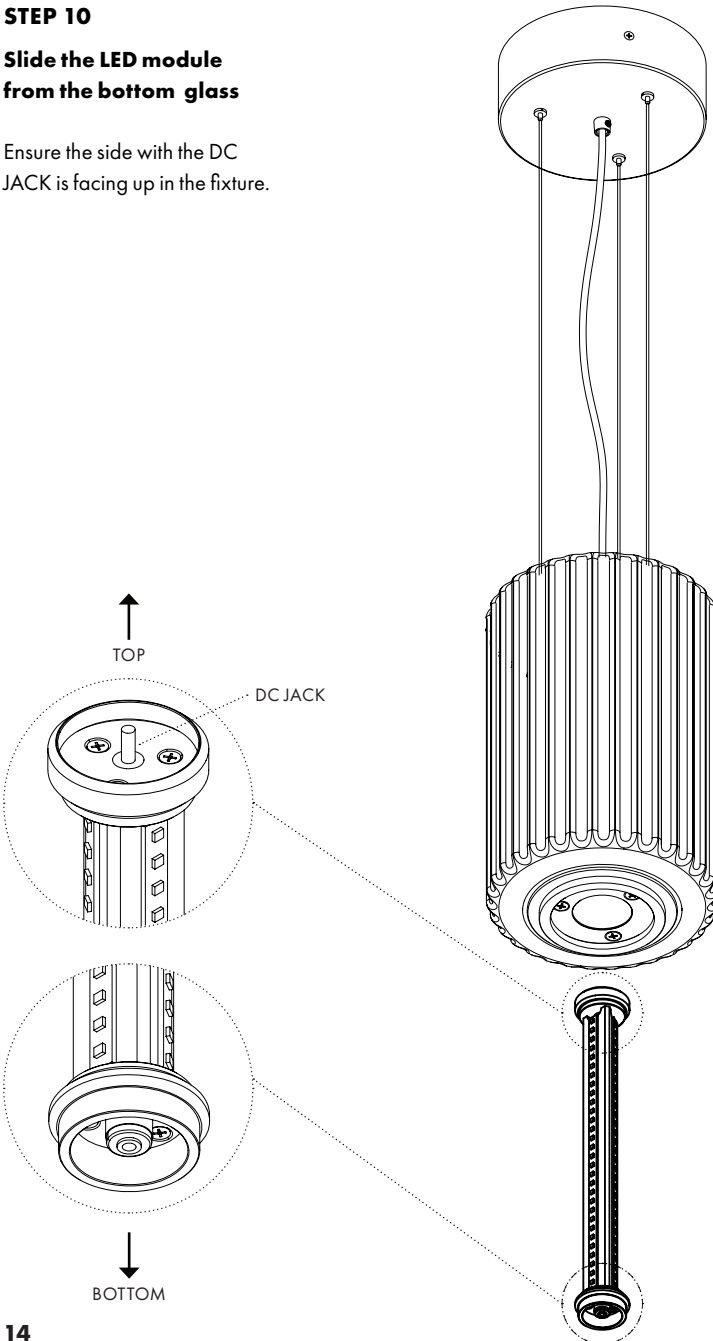

STEP 11

Thread the endcap on the bottom glass.

Attention!

Do not drop the LED module while threading on the endcap.

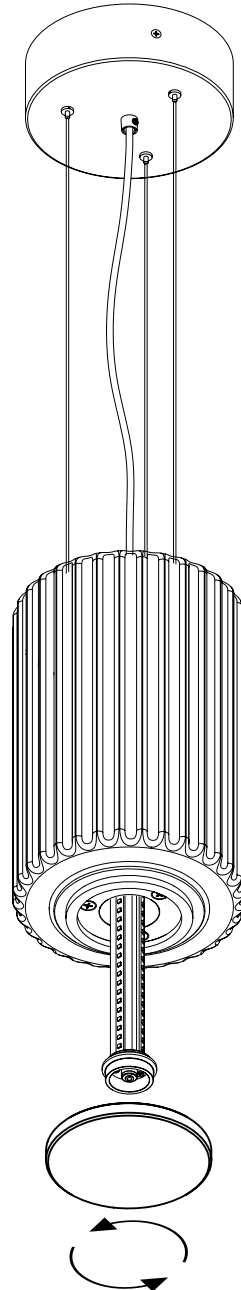

INSTALLATION

STEP 14

i) Connect the electrical cord to the light fixture and adjust the swag.

The powercord should have some slack as pictured here.

ii) Tighten the plastic strain relief to secure the power cord.

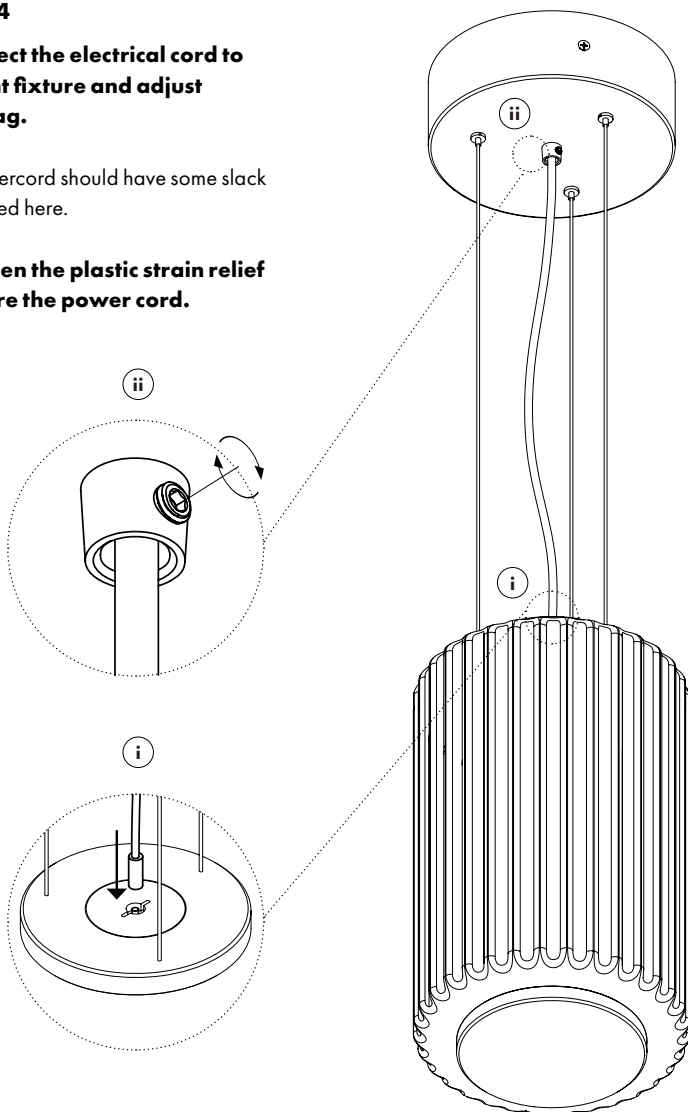

For support, please contact:
info@a-n-d.com
+1 604 563 6938

A-N-D

1951 Franklin St,
Vancouver, BC
Canada V5L 0C7