

Pablo®

# CIRCA FLUSH

120V

**ASSEMBLY & INSTALLATION INSTRUCTIONS**



# CIRCA FLUSH

**IMPORTANT: WE RECOMMEND FIXTURE BE INSTALLED BY AN ELECTRICIAN**

**WARNING: FIXTURE MUST BE WIRED CORRECTLY OR RISK DAMAGE TO COMPONENTS**

**CIRCA FLUSH MODELS:**

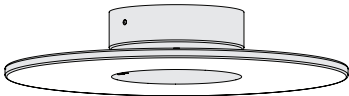

CIRCA FLUSH DIRECT  
(CEILING MOUNTED)

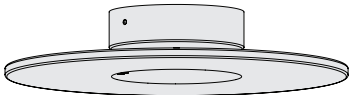

CIRCA FLUSH INDIRECT  
(CEILING MOUNTED)

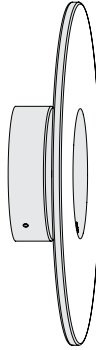

CIRCA FLUSH DIRECT  
(WALL MOUNTED)

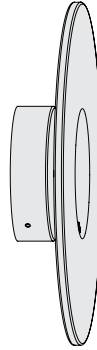

CIRCA FLUSH INDIRECT  
(WALL MOUNTED)

**NOTE: INSTRUCTIONS SHOW INSTALLATION OF CIRCA FLUSH DIRECT CEILING MOUNTED, FOLLOW THE SAME INSTRUCTIONS FOR ALL CONFIGURATIONS LISTED ABOVE**

**COMPONENT LIST**

- A TRANSFORMER
- B MOUNTING PLATE
- C JUNCTION BOX SCREWS
- D CANOPY SCREWS
- E CANOPY COVER
- F LAMP HEAD

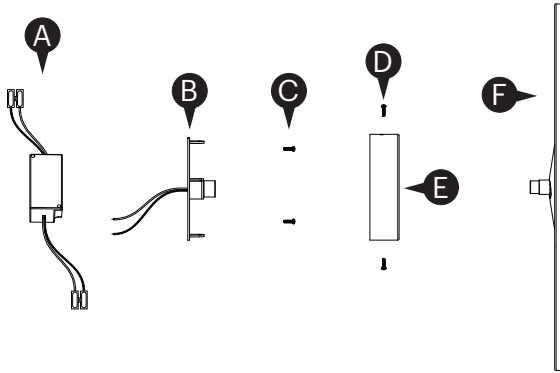

**1** CONNECT BUILDING WIRING TO 2 POLE CONNECTOR ON AC INPUT SIDE OF TRANSFORMER

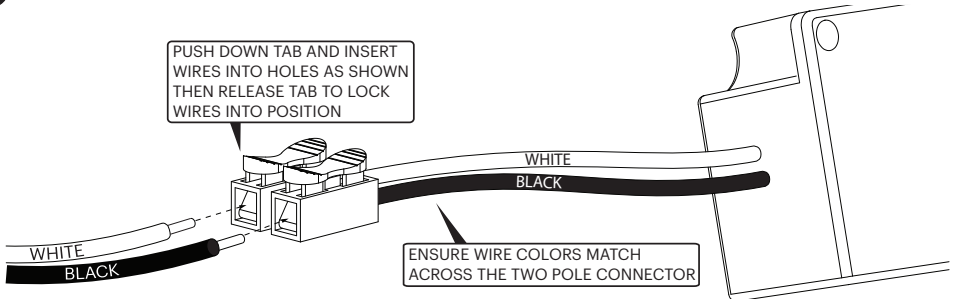

# CIRCA FLUSH

- 2** CONNECT **FIXTURE WIRING** ON MOUNTING PLATE TO 2 POLE CONNECTOR ON **DC OUTPUT** SIDE OF TRANSFORMER

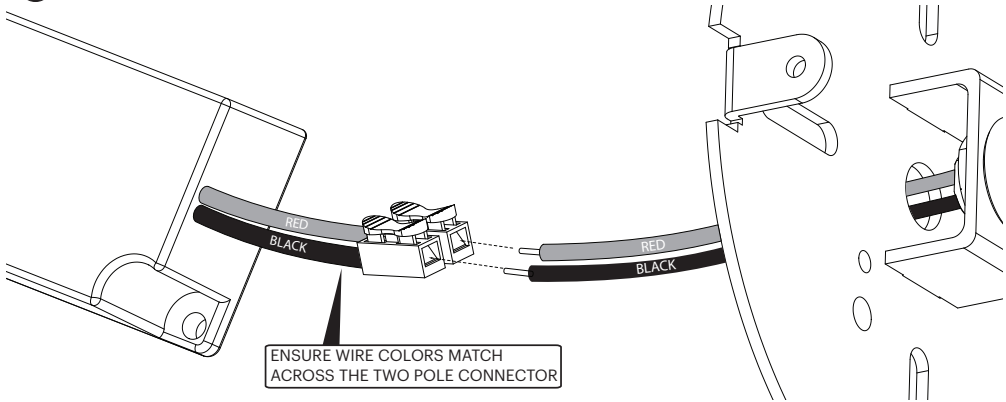

TUCK TRANSFORMER AND WIRING INTO JUNCTION BOX AND SCREW MOUNTING PLATE INTO JUNCTION BOX USING PROVIDED MACHINE SCREWS

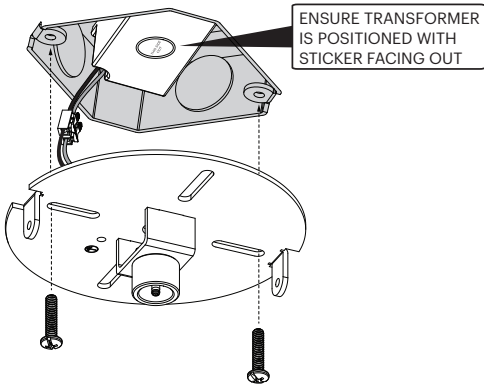

- 4** FASTEN CANOPY COVER TO MOUNTING PLATE USING PROVIDED MACHINE SCREWS

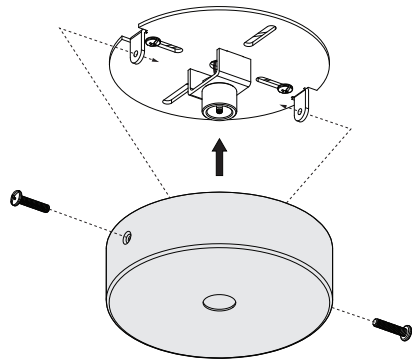

- 5** HOLD OUTSIDE OF SHADE WITH BOTH HANDS AND SCREW FIXTURE HEAD INTO CANOPY ASSEMBLY

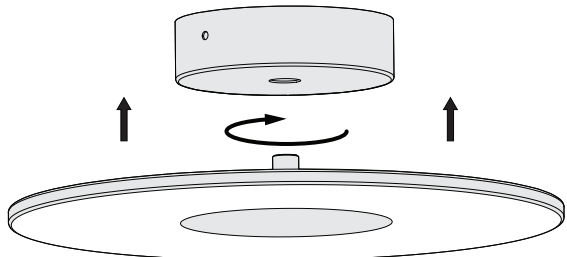

**BULB TYPE**  
LED FLAT PANEL

**BULB REPLACEMENT**  
CONTACT MANUFACTURER  
FOR BULB REPLACEMENT

**ELECTRONIC**  
LOW VOLTAGE DIMMER  
RECOMMENDED

**Pablo\***

CIRCA

FLUSH

INFO@PABLODESIGNS.COM  
888 MARIN STREET  
SAN FRANCISCO, CA  
94124

PABLODESIGNS.COM